



New JUNE 2023 HARVEST MINISTRIES Int'l Inc

"REACHING AROUND THE WORLD WITH THE WORD"

But blessed is the one who trusts in the Lord, whose confidence is in Him. They will be like a tree planted by the water that sends out its roots by the stream. It does not fear when heat comes: its leaves are always green. It has no worries in a year of drought and never fails to bear fruit.

Jeremiah 17:7-8

We praise God for the expansion of Kingdom work spreading throughout Africa, India, and the world! How wondrous it is to watch the work of the Lord flourish and bear fruit as new wells are dug, widows & orphans are loved and cared for, and lives are forever impacted by the Gospel of Christ. Blessed be the name of our God for His great faithfulness!

How grateful we are for your partnership in spreading the good news! Thank you for co-laboring with us in all that God is doing in the nations. May you be richly blessed as we continue to grow in:

"Reaching Around the World with the Word."

India: Light Way Ministries

Pastor Sukumar distributed rice bags and grocery kits to widows and families in need in the tribal village of **Ramannapalem**.

There were **25** families who received much needed supplies.



VBS celebrations at Pastor Sukumar's Church in **Rajahmundry**!



India: Faith in Action Ministries India

On May 10th, **Arputha Suresh** celebrated his **wedding** and is now on holiday with his new wife!

Brother to Pastor David's wife **Usha**, he is also the caretaker for the boys at the orphanage in **Tamil Nadu**.



Tanzania

The Nursery School and Pre-School classes held in buildings on the church grounds have been very successful and now a **K – 8th grade school is needed** for the next phase of the education process.

Thanks to a generous partner family, a **well has now been placed** on the 4 acre property where the school is to be built. Pastor Laban has formulated a plan for constructing the elementary school building.

The **first phase** is to construct the Administrative Offices, Kitchen, Bathrooms, Playground along with the first few classrooms. The estimated cost is **\$48,000**.

The **second phase** will provide more classrooms to be added for the promoted grades. The cost will be determined at the time this phase is implemented.

Prayerfully consider partnering with us to complete this vital program.

These children are receiving a **Christian based, English speaking education**. It would be a great project for your church, youth group, prayer group or family to embrace!

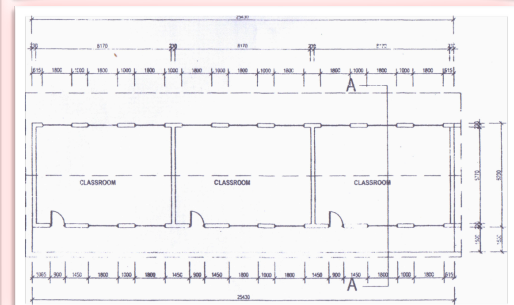
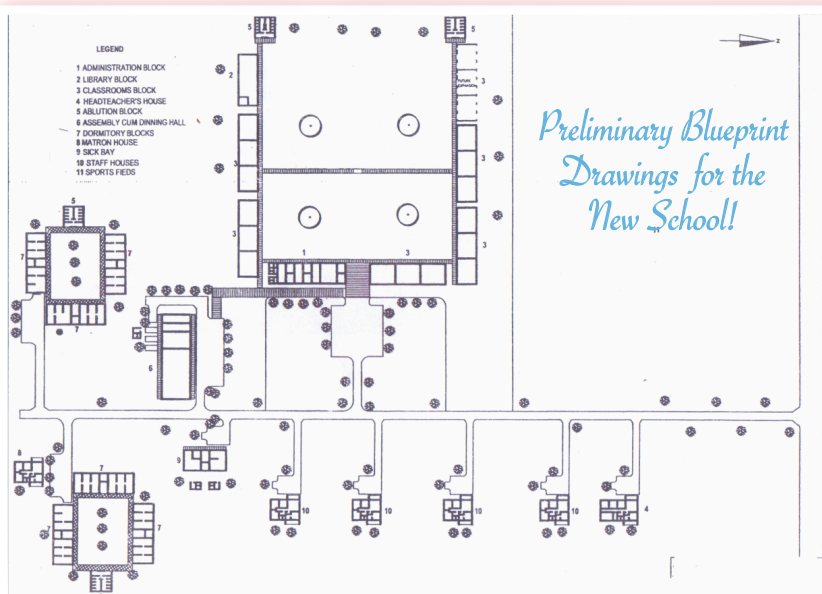



Held at **9AM** the **2ND** Saturday of each month at the NHMI office.

We are located at:

100 Pine St. Zeeland, MI 49464

USE THE “**G**” DOOR ON THE WEST SIDE OF THE BUILDING.

NEW HARVEST MINISTRIES INTERNATIONAL INC.



P.O. Box 1011, Holland, MI 49422



(616) 748-8888



newharvestministriesintl@gmail.com



www.newharvest.org



Jean & the late Herb Stewart
Founder

New Harvest Ministries Int'l has seen over 1,000,000 souls respond to the Gospel of Christ around the world.



Dale & Jeanne Scholten
President

REACHING AROUND THE WORLD WITH THE WORD

New Harvest Ministries provides:

India

The care of orphans and widows, a day school, and the training of pastors

Gospel outreach in remote villages and vocational training for widows

Graduates from the Bible College have established over 90 churches

Over 100 wells have been drilled in remote villages bringing fresh water to over 100,000 people

Tanzania

There are 9 branches of New Harvest Bible College with over 1,300 graduates

Over 185 churches have been established throughout Tanzania, Burundi, Kenya, Uganda, Malawi, and Democratic Republic of Congo

A medical/maternity clinic, a nursery school, 2 cafe locations, a metal fabrication shop and training, a brick manufacturing shop, a 3,000 acre agricultural project, and wells are being drilled

Cuba

Pastors seminars and church services continue to encourage and inspire pastors and leaders



New Harvest Ministries Int'l Inc.

P.O. Box 1011
Holland, MI 49422-1011

Reaching Around the World with the Word.

NON-PROFIT ORG.
U.S. POSTAGE

PAID

HOLLAND, MI 49423
PERMIT #554

**Return Service
Requested**

FEATURED THIS MONTH



Did you know?

Pastor Laban's wife **Anna** opened a restaurant in Mpanda called "**Laban's Sweet Corner**." It has grown so much they opened a second location!

Through the restaurant business, **Anna equips women** with various skillsets through cooking and serving that they can in turn utilize to **bless** their families and those around them.

Featured in her restaurant are a variety of delicious fish and chicken dishes. It has become a **popular destination** among the locals and is a tremendous opportunity to enrich the community and **share the love of Jesus** to those in Mpanda, Tanzania!